

**MITSUBISHI ELECTRIC**

**GOT2000 Series Protective Sheet for GT27/GT25/GT23**

**User's Manual**

GT27-15PSCC GT25-05PSCC  
 GT27-15PSGC GT25-05PSGC  
 GT25-12PSCC GT25-12PSGC  
 GT25-12PSGC GT25-12PSGC  
 GT25-10PSCC GT25-10PSGC  
 GT25-10PSGC GT25-08PSCC  
 GT25-08PSCC GT25-08PSGC

Thank you for purchasing the GOT2000 Series.

**Prior to use, please read both this manual and detailed manual thoroughly to fully understand the product.**

MODEL	GT27/GT25-PS-U-JE
MODEL CODE	1D7MH9
IB(NA)-0800499-C(1504)MEE	

**GOT2000**

**[DISPOSAL PRECAUTIONS]**

**CAUTION**

- Dispose of this product as industrial waste.

**[TRANSPORTATION PRECAUTIONS]**

**CAUTION**

- When fumigants that contain halogen materials such as fluorine, chlorine, bromine, and iodine are used for disinfecting and protecting wooden packaging from insects, they cause malfunction when entering our products. Please take necessary precautions to ensure that remaining materials from fumigant do not enter our products, or treat packaging with methods other than fumigation (heat method). Additionally, disinfect and protect wood from insects before packing products.

**Manuals**

The following shows manuals relevant to this product.

**Detailed Manual**

Manual name	Manual number (Model code)
GOT2000 Series User's Manual (Hardware) (Sold separately)	SH-081194ENG (1D7MJ5)

For detailed manuals, refer to the PDF manuals stored in the DVD-ROM for the drawing software used.

**Relevant Manuals**

For relevant manuals, refer to the Help or the .PDF manuals stored in the DVD-ROM for the drawing software used.

The latest manuals are also available from MITSUBISHI ELECTRIC FA Global Website (<http://www.MitsubishiElectric.co.jp/fa/>).

© 2013 MITSUBISHI ELECTRIC CORPORATION

**Packing List**

After unpacking the box, check that the following products are included.

Model	Product	Quantity
GT27-15PSCC GT27-15PSGC GT25-12PSCC GT25-12PSGC GT25-10PSCC GT25-10PSGC GT25-08PSCC GT25-08PSGC GT25-05PSCC GT25-05PSGC GT25-12PSCC-UC GT25-10PSCC-UC GT25-08PSCC-UC	GOT2000 series protective sheet	5
GT27-15PSCC GT27-15PSGC GT25-12PSCC GT25-12PSGC GT25-10PSCC GT25-10PSGC GT25-08PSCC GT25-08PSGC GT25-05PSCC GT25-05PSGC GT25-12PSCC-UC GT25-10PSCC-UC GT25-08PSCC-UC	GOT2000 Series Protective Sheet for GT27/GT25/GT23 User's Manual (This manual)	1

**SAFETY PRECAUTIONS**

(Always read these precautions before using this equipment.)

Before using this product, please read this manual and the relevant manuals introduced in this manual carefully and pay full attention to safety to handle the product correctly.

The precautions given in this manual are concerned with this product. In this manual, the safety precautions are ranked as "WARNING" and "CAUTION".

**WARNING** Indicates that incorrect handling may cause hazardous conditions, resulting in death or severe injury.

**CAUTION** Indicates that incorrect handling may cause hazardous conditions, resulting in medium or slight personal injury or physical damage.

Note that the CAUTION level may lead to a serious accident according to the circumstances. Always follow the precautions of both levels because they are important to personal safety. Please save this manual to make it accessible when required and always forward it to the end user.

**[INSTALLATION PRECAUTIONS]**

**CAUTION**

- When attaching the protective sheet onto the GOT display section, make sure to fit the protective sheet onto the section closely without leaving any air between them. Failure to do so may cause a malfunction!

**[STARTUP AND MAINTENANCE PRECAUTIONS]**

**WARNING**

- Daily check the protective sheet with eyes. When you find extreme dirt or scratches on the surface, immediately replace it with new one. Using the protective sheet of decreased visibility may cause a malfunction.

**4. ATTACHING AND REMOVING**

For attaching and removing the protective sheet, refer to the example of the GT2712.

- If the old protective sheet is attached, slowly remove the sheet from the finger grip part of the lower right of the GOT. Clean the GOT surface.

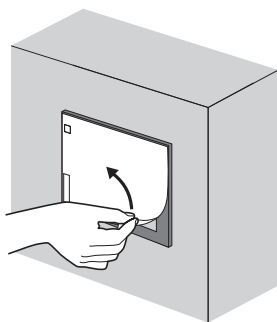

- Peel the release paper off the back of the new protective sheet. Position the hole for the USB environmental protection cover of the protective sheet to the USB environmental protection cover of the GOT. If the protective sheet without the hole for the USB environmental protection cover is attached, position the sheet from the upper left of the GOT.

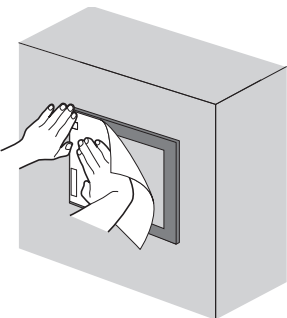

- To attach the protective sheet, attach it from one direction gradually. Make sure to fit the protective sheet onto the joining surface closely without leaving any air between them. Attach the protective sheet with adding additional pressure sufficiently to the adhesive side of the outer circumference. To hold adequate strength of the adhesive joining, use the GOT after a lapse of about 24 hours.

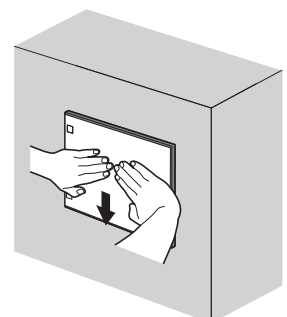

**5. PRECAUTIONS FOR USE**

- The protective sheet is consumable supplies. If you find scratches or extreme dirt by the periodic check, replace it with new one.
- Do not push the protective sheet with something whose point is sharp, such as a mechanical pencil or screwdriver. Doing so may cause scratches or be damaged.
- Do not wash the protective sheet with using bleach, thinner, organic solvent, caustic chemical, and others. Doing so may change in shape or color.
- Do not expose the protective sheet to direct sunlight. If the protective sheet gets dust, wipe the sheet with a damp cloth.

**1. OVERVIEW**

This User's Manual describes GOT 2000 series protective sheet (hereinafter referred to as the protective sheet). Use the protective sheet to protect the display section surface from scratches and dirt when operating the touch keys on the GOT display section.

The following table shows the protective sheets and the screen sizes for the applicable GOTs

Model	Screen sizes for the applicable GOTs
GT27-15PSCC GT27-15PSGC	15"
GT25-12PSCC GT25-12PSGC GT25-12PSCC-UC	12.1"
GT25-10PSCC GT25-10PSGC GT25-10PSCC-UC	10.4"
GT25-08PSCC GT25-08PSGC GT25-08PSCC-UC	8.4"
GT25-05PSCC GT25-05PSGC	5.7"

**2. SPECIFICATIONS**

The following shows the performance specifications of the protective sheet. The general specifications for the protective sheet are the same as those of the GOT. For the general specifications of the GOT, refer to the GOT2000 Series User's Manual (Hardware). Select a clear protective sheet for the display intensity, or select an antiglare protective sheet for antireflection.

Product	Model	Description
Protective sheet	GT27-15PSCC	15" Clear type
	GT27-15PSGC	15" Antireflection type
	GT25-12PSCC	12.1" Clear type
	GT25-12PSGC	12.1" Antireflection type
	GT25-10PSCC	10.4" Clear type
	GT25-10PSGC	10.4" Antireflection type
	GT25-08PSCC	8.4" Clear type
	GT25-08PSGC	8.4" Antireflection type
	GT25-05PSCC	5.7" Clear type
	GT25-05PSGC	5.7" Antireflection type
	GT25-12PSCC-UC	12.1" Clear type, USB cover type
	GT25-10PSCC-UC	10.4" Clear type, USB cover type
	GT25-08PSCC-UC	8.4" Clear type, USB cover type

**3. EXTERNAL DIMENSIONS**

GT27-15PSCC, GT27-15PSGC, GT25-12PSCC, GT25-12PSGC, GT25-10PSCC, GT25-10PSGC, GT25-08PSCC, GT25-08PSGC, GT25-05PSCC, GT25-05PSGC

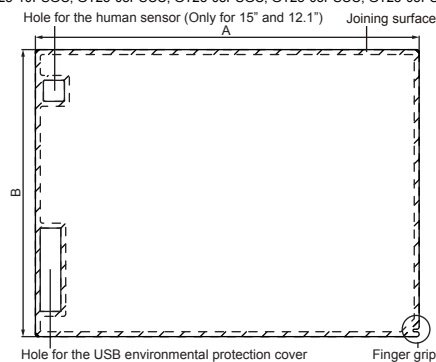

GT25-12PSCC-UC, GT25-10PSCC-UC, GT25-08PSCC-UC

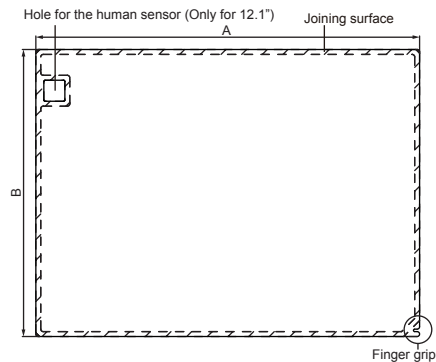

Item	A	B
15" protective sheet	392(15.4)	287(11.3)
12.1" protective sheet	312(12.3)	234(9.21)
10.4" protective sheet	299(11.8)	206(8.11)
8.4" protective sheet	237(9.33)	182(7.17)
5.7" protective sheet	163(6.42)	127(5.00)

Unit: mm (inch)

**Warranty**

Mitsubishi will not be held liable for damage caused by factors found not to be the cause of Mitsubishi; machine damage or lost profits caused by faults in the Mitsubishi products; damage, secondary damage, accident compensation caused by special factors unpredictable by Mitsubishi; damages to products other than Mitsubishi products; and to other duties.

**For safe use**

- This product has been manufactured as a general-purpose part for general industries, and has not been designed or manufactured to be incorporated in a device or system used in purposes related to human life.
- Before using the product for special purposes such as nuclear power, electric power, aerospace, medicine or passenger movement vehicles, consult with Mitsubishi.
- This product has been manufactured under strict quality control. However, when installing the product where major accidents or losses could occur if the product fails, install appropriate backup or failsafe functions in the system.

Country/Region	Sales office/Tel
U.S.A	Mitsubishi Electric Automation Inc. 500 Corporate Woods Parkway Vernon Hills, IL 60061, U.S.A. Tel : +1-847-478-2100
Brazil	MELCO-TEC Rep. Com.e Assessoria Tecnica Ltda. Rua Correia Dias, 184, Edificio Paraiso Trade Center-8 andar Paraiso, Sao Paulo, SP Brazil Tel : +55-11-5908-8331
Germany	Mitsubishi Electric Europe B.V. German Branch Gothaer Strasse 8 D-40880 Ratingen, GERMANY Tel : +49-2102-486-0
U.K	Mitsubishi Electric Europe B.V. UK Branch Travellers Lane, Hatfield, Hertfordshire., AL10 8XB, U.K. Tel : +44-1707-276100
Italy	Mitsubishi Electric Europe B.V. Italian Branch Centro Dir. Colleoni, Pal. Perseo-Ingr.2 Via Paracelso 12, I-20041 Agrate Brianza., Milano, Italy Tel : +39-039-60531
Spain	Mitsubishi Electric Europe B.V. Spanish Branch Carretera de Rubi 76-80, E-08190 Sant Cugat del Valles, Barcelona, Spain Tel : +34-93-565-3131
France	Mitsubishi Electric Europe B.V. French Branch 25, Boulevard des Bouvets, F-92741 Nanterre Cedex, France Tel : +33-1-5568-5568
South Africa	Circuit Breaker Industries Ltd. Private Bag 2016, ZA-1600 Isando, South Africa Tel : +27-11-928-2000
Hong Kong	Mitsubishi Electric Automation (Hong Kong) Ltd. 10th Floor, Manulife Tower, 169 Electric Road, North Point, Hong Kong Tel : +852-2887-8870
China	Mitsubishi Electric Automation (China) Ltd. 4/F Zhi Fu Plazz, No.80 Xin Chang Road, Shanghai 200003, China Tel : +86-21-6120-0808
Taiwan	Setsuyo Enterprise Co., Ltd. 6F No.105 Wu-Kung 3rd.Rd, Wu-Ku Hsiang, Taipei Hsine, Taiwan Tel : +886-2-2299-2499
Korea	Mitsubishi Electric Automation Korea Co., Ltd. 1480-6, Gayang-dong, Gangseo-ku Seoul 157-200, Korea Tel : +82-2-3660-9552
Singapore	Mitsubishi Electric Asia Pte. Ltd. 307 Alexandra Road #05-01/02, Mitsubishi Electric Building, Singapore 159943 Tel : +65-6470-2460
Thailand	Mitsubishi Electric Automation (Thailand) Co., Ltd. Bang-Chan Industrial Estate No.111 Moo 4, Serithai Rd, T.Kannayao, A.Kannayao, Bangkok 10230 Thailand Tel : +66-2-517-1326
Indonesia	P.T. Autoteknindo Sumber Makmur Muara Karang Selatan, Block A/Utara No.1 Kav. No.11 Kawasan Industri Pergudangan Jakarta - Utara 14440, P.O.Box 5045 Jakarta, 11050 Indonesia Tel : +62-21-6630833
India	Messung Systems Pvt. Ltd. Electronic Sadan NO:III Unit No15, M.I.D.C Bhosari, Pune-411026, India Tel : +91-20-2712-3130
Australia	Mitsubishi Electric Australia Pty. Ltd. 348 Victoria Road, Rydalmere, N.S.W 2116, Australia Tel : +61-2-9684-7777

**MITSUBISHI ELECTRIC CORPORATION**

HEAD OFFICE : TOKYO BUILDING, 2-7-3 MARUNOUCHI, CHIYODA-KU, TOKYO 100-8310, JAPAN  
 NAGOYA WORKS : 1-14, YADA-MINAMI 5-CHOME, HIGASHI-KU, NAGOYA, JAPAN

When exported from Japan, this manual does not require application to the Ministry of Economy, Trade and Industry for service transaction permission.

Specifications subject to change without notice.  
 Printed in Japan, April 2015.